



COR VISION SYSTEM

CORTIZO has designed more than 50 exclusive systems of windows, façades, composite panel and solar protection systems. This commitment to innovation allows us to offer high value added products, maximizing energy efficiency, thermal and acoustic insulation and resistance to atmospheric agents.

INNOVATION

TECHNOLOGY

QUALITY

EFFICIENCY

GUARANTEE

SUSTAINABILITY

AESTHETIC

FUNCTIONALITY

DESIGN

COMFORT

R+D+I

COR VISION SYSTEM



Sliding system with Thermal Break of avant-garde design seeking maximum brightness with the minimum amount of seen aluminum profile centre junction section in the market, only 2cm. and allows enclosing large openings of up to 13.2 (width) x 3 (height) metres in 6 sashes.

An elegance in design with the possibility of meetings at a 90° corner without mullions, achieving clear open spaces to enjoy the outside view.

- Valores máximos en eficiencia energética: transmitancia de ventana desde 1,3 (W/m²K)*.
- Máxima protección frente al ruido: hasta 41 dB de reducción acústica.

CATEGORÍAS ALCANZADAS EN BANCO DE ENSAYOS*

Permeabilidad al aire	CLASE 4 (máxima)
Estanqueidad al agua	CLASE 7A
Resistencia al viento	CLASE C5 (máxima)

POSIBILIDADES DE APERTURA

Corredera de 2, 3, 4 y 6 hojas.
Posibilidad tricarril.
Monocarril (1 hoja+1 fijo).
En esquina a 90° sin parteluz.
Galandage de 1 y 2 hojas.

*CONSULT TYPOLGY, DIMENSION AND GLASS.



RESISTANCE TO ATMOSPHERIC AGENTS [CORTIZO COMFORT]

All of CORTIZO's enclosing systems are tested in the Test Laboratory at the Technological Center to guarantee the best performance in watertightness, air permeability and wind loads, endorsed by the maximum results in its test qualifications.

THERMAL INSULATION [CORTIZO ENERGY EFFICIENCY]

Nowadays energy efficiency in buildings is a demand made, both by the architects, as by the final customer aware of the importance of saving on heating costs and air conditioner. CORTIZO meets such challenge with systems for every climatic area with a high insulation coefficient to ensure the comfort in the residence.

ACOUSTIC INSULATION [CORTIZO SILENCE]

In order to transform the residence into a private space, intimate and free of pollution outdoor acoustics, CORTIZO has designed its enclosing systems with all the latest technological developments necessary to ensure indoors peace and relax.

UNLIMITED COLOUR RANGE [CORTIZO COLOURS]

The whole RAL colour chart in powder coating, exclusive powder coating, metallic, textured, wood effect, more than 100 finishes in anodized. Aluminum on the outside and wood in the inside, two-coloured finishes... An unlimited offer to create a colour harmony at home. Quality labels in every process: QUALICOAT, SEA-SIDE, QUALIDECO and QUALANOD.

AVANT-GARDE AESTHETICS [CORTIZO DESIGN]

We create tailor-made windows and façades for every project. Creativity to answer aesthetically and functionally to each demand. Aesthetic answers to the technical needs. Creativity at the service of habitable environments.

ENCLOSURES FOR LIFE [CORTIZO DURABILITY]

Aluminum is the most durable, long-standing and resistant material of those used in enclosures. Aluminum has the strength and a durability of the things that last a whole lifetime.

SUSTAINABLE SPIRIT [CORTIZO SUSTAINABILITY]

Respect for the environment is CORTIZO'S commitment. Using innocuous raw materials and products in all our manufacturing process and the limitless possibility of aluminum recycling, allows us to remove any creation of waste and environmental risks.



FOR MORE
INFORMATION
CONSULT
OUR WEB

www.cortizo.com

Sistema / System
➤ **COR VISION PLUS**



CERRAMIENTOS CONTEMPORÁNEOS
CONTEMPORARY ENCLOSURES







Muestra ensayada por / Sample tested by
ALUMINIOS CORTIZO S.A.U.



Transmitancia / Transmittance

$U_w \geq 0,9$ (W/m²K)

Consultar tipología, dimensión y vidrio.
Consult typology, dimensions and glass.

CTE - Apto para zonas climáticas*: α A B C D E

*En función de la transmitancia del vidrio.

Aislamiento acústico / Accoustic insulation

Máximo acristalamiento
Maximum glazing **54 mm**

Máximo aislamiento acústico
Maximum accoustic insulation **Rw = 43 dB**

Secciones Sections

Marco / Frame 180 mm
278 mm tricarril
3 rails

Espesor perfilera Profile thickness

Puerta / Door 2,0 mm

Hoja / Sash 69 mm

Longitud varilla poliamida Marco / Frame 40 mm
Polyamide strip length Hoja / Sash 18 - 32 mm

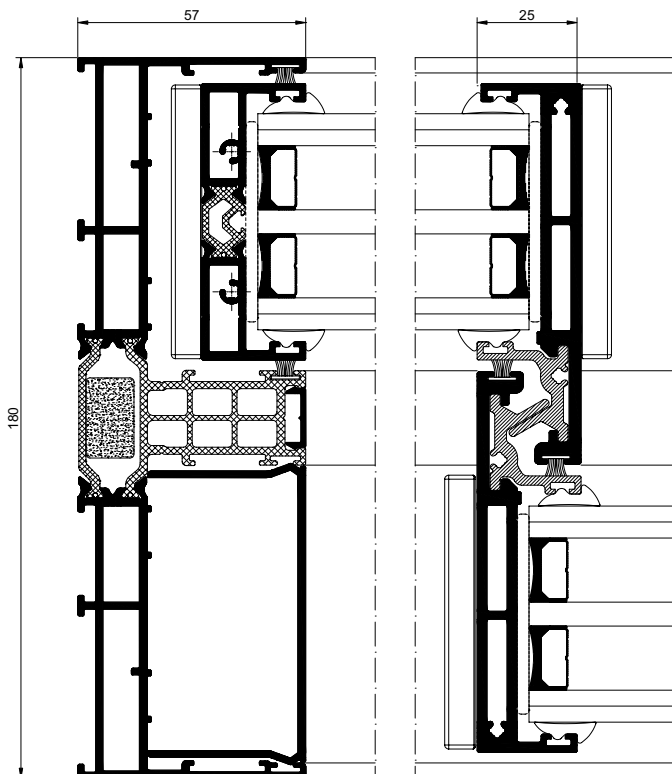

Categorías alcanzadas en banco de ensayos Categories achieved at test centre

Permeabilidad al aire / Air permeability
(UNE-EN 12207:2000): **Clase / Class 4**

Estanqueidad al agua / Water tightness
(UNE-EN 12208:2000): **Clase / Class 7A*/9A****

Resistencia al viento / Wind resistance
(UNE-EN 12210:2000): **Clase / Class C3**

* Ensayo de referencia balconera 4,00 x 3,00 m, 2 hojas.
Reference test balcony 4,00 x 3,00 m, 2 sashes.

** Ensayo de referencia balconera 4,00 x 3,00 m, 1 hoja + 1 fijo.
Reference test balcony 4,00 x 3,00 m, 1 sash + 1 fixed light.

Acabados / Finishes

Posibilidad bicolor / Possibility of dual colour
Lacado colores (RAL, moteados y rugosos) / Colour powder coating (RAL, mottled & rough)
Lacado imitación madera / Wood effect powder coating
Lacado antibacteriano / Anti-bacterial powder coating
Anodizado / Anodized

Posibilidades de apertura Opening possibilities

Corredera de 1, 2, 3, 4 y 6 hojas.
Posibilidad monocarril, bicarril y tricarril.
Posibilidad de apertura en esquina y rincón a 90° sin parteluz.
Posibilidad de galandage 1,2,3 y 4 hojas.

Sliding of 1, 2, 3, 4 & 6 sashes.
Possibility of 1, 2 or 3 rails.
Possibility of interior and exterior corner sash at 90° without mullion.
Galandage possibility in 1, 2, 3 & 4 sashes.

Dimensiones máximas/hoja Maximum dimensions/sash

Ancho / Width (L) = 4.000 mm

Alto / Height (H) = 4.000 mm

Consultar peso y dimensiones máximas según tipología.
Consult maximum weight and dimensions in accordance to typology.

Peso máximo/hoja 400 Kg Manual / Manual
Maximum weight/sash 700 Kg Motorizada / Motorized

Diego Piñeiro Janeiro
Director de I+D+i / R&D Manager